

產品簡介

- ◆設計簡單，結構緊湊，重量輕，壽命長以及較高的夾持力使它成爲一種完美的夾具。
- ◆本產品有可加裝感應器
- ◆可任意選擇上面和下面及側面安裝。
- ◆壓板需增加長度時，請勿大于原長度之1.5倍。



Introduction of product

- ◆This product is perfect , Design in brief,the structure is compact, the weight is light,the service life is long and holding capacity is strong.
- ◆You can install an inductor on this product if you need.
- ◆Fixing from top , base or the side of cylinder is ok.
- ◆When you need to increase the length of the clamping arm, please don't exceed 1.5 times of the original length.

特性資料 Specification

氣缸內徑	Bore of cylinder(mm)	Φ25	Φ32	Φ40	Φ50	Φ63
活塞杆徑	Bore of piston (mm)	14	16	16	20	20
轉角行程	Swing stroke(mm)	13	16	15	17	15
垂直行程	Clamping stroke (mm)	14		15		
受壓面積拉入/推出	Pressure area pull/push cm ²	3.37/4.9	6.03/8.03	10.56/12.56	16.48/19.62	28.01/31.15
理論夾持力 (5kg/cm ²)	Clamping force	16(kg)	30(kg)	50(kg)	80(kg)	140(kg)
使用流體	Fluid	已濾清之壓縮空氣 Filtered air				
最大耐壓力	Max pressure(kg/cm ²)	10kg/cm ²				
使用壓力範圍	Range of pressure (kg/cm ²)	4---7kg/cm ²				
轉角方向	Rotating direction	左轉L或右轉R Turn right R or turn left L				
轉角角度	Rotating angle	標準角度Standard angle 90° ±2°				
作動方式	Acting type	復動式 Double acting				

①	系列號 Series	HPSB
②	轉角方向 Rotating direction	右轉R或左轉L Turn right R or turn left L
③	氣缸內徑 Bore of cylinder	Φ25, Φ32, Φ40, Φ50, Φ63
④	轉角角度 Rotating angle	標準角度 Standard angle 90°
⑤	近接開關 Sensor switch	S1:1個 S2:2個 1Pcs of S1 2Pcs of S2

訂購標示法 Ordering Code

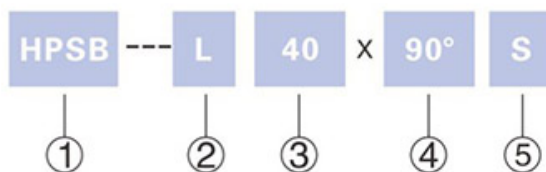

訂購舉例：如需求一缸徑Φ40，左轉90°的HPSB系列轉角缸

正確型號是：HPSB-L40x90°

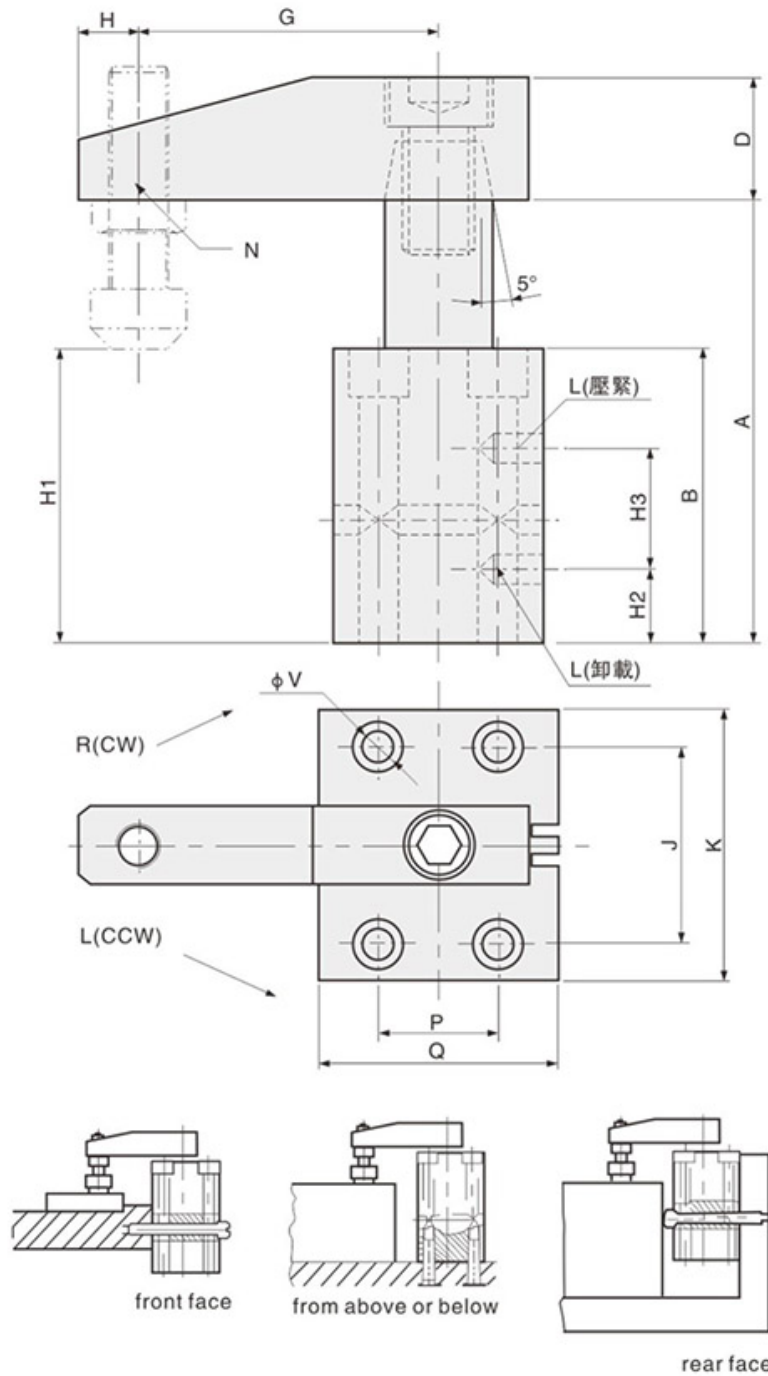

外形尺寸表 Dimension table

單位 (Unit) :mm

ITEM MODEL	A	B	D	G	H	H1	H2	H3	J	K	L	N	P	Q	ΦV
HPSB-25	109	78	16x16	50	6	57-65	14.5	47.5	40	55	M5x0.8	M6x1	20	35	Φ6.5
HPSB-32	126	90	19x19	60	9	60-73	21	51.5	45	60	PT1/8	M8x1.25	30	45	Φ6.5
HPSB-40	126	90	19x19	70	9	60-73	22	49	52	70	PT1/8	M8x1.25	37	55	Φ8.5
HPSB-50	137	100	25x25	80	10	55-75	25	53.5	66	85	PT1/8	M12x1.75	46	65	Φ8.5
HPSB-63	137	100	25x25	90	10	55-75	28	52	80	100	PT1/8	M12x1.75	60	80	Φ10.5